

# VR Works for SC

**HELP AHEAD**



## The Roadmap for Results

South Carolina Vocational Rehabilitation Association  
2013 Annual Meeting

DoubleTree Suites by Hilton  
Columbia, South Carolina

- 
- PROSTHETICS
  - ORTHOTICS
  - POWER MOBILITY
  - DURABLE MEDICAL EQUIPMENT
  - RESPIRATORY



**RME**  
**RELIABLE MEDICAL EQUIPMENT**  
**OF SOUTH CAROLINA**

**418 BROAD STREET**  
**SUMTER, SOUTH CAROLINA 29150**  
**803.934.9212 • FAX 803.934.0750**

# Sunday, January 27

4:00-5:00 P.M.

Exhibitors set up..... Congaree B

5-6:00 P.M.

Registration & Visit Exhibits..... Congaree B Pre-Function

6:00-6:45 P.M.

**Division Meetings**

- Administrators' Association ..... Richland
- Client Services Association ..... Fairfield
- SC Association of Disability Examiners ..... Newberry
- Technical Services Association ..... Capital

6:45-7:30 P.M.

**SCVRA Business Meeting** ..... Saluda/Calhoun

**Presiding:**

Houston Matthews, SCVRA President, presiding

**Reports**

**Election of Officers**

**Divisional Awards**

***Administrator of the Year***

*Presented by: Chad Ulmer, SCVRAA President*

***Client Services Award***

*Presented by: Ali Cato, CSA President*

***Barry Cooper Award (SCADES)***

*Presented by Chris Porter, DDS Regional Supervisor*

***Technical Services Award***

*Presented by Sam Hamilton, TSA President*

7:30-8:45 P.M.

Reception ..... Congaree A

9:00-10:30 P.M.

Bowling Night Out ..... AMF Columbia Lanes

# Monday, January 28

8:30 A.M.–9:00 A.M.

**Registration & Visit Exhibits ..... Congaree B Pre-Function**

9–10:15 A.M.

**General Session ..... Congaree A**

**Welcome**

*Houston Matthews, SCVRA President*

**Presentation of Colors**

*Dutch Fork High School Junior ROTC, Columbia*

**National Anthem**

*Rhonda Warren, QA Review Specialist*

**Introduction of Speaker**

*Mark Wade, Assistant Commissioner*

**Guest Speaker**

*Carl R. Wells, Ph.D Assistant Director, Office of Equal Opportunity Programs, USC*

10:15–10:30 A.M.

**Break / Visit Exhibit Area..... Congaree B**

10:30–11:10 A.M.

**Concurrent Sessions I (choose one)**

**Leadership Actions that Activate Empowerment and Accountability..... Richland**

*Sheri Callahan identifies the importance of job ownership and how it is the foundation of a happy and well performing team. Guides leaders to promote problem solving, creative thinking, identifies the key steps in meaningful delegation, and how to lead cautious risk taking within guidelines. The issues of leadership trust and control will also be examined. A key session for both positional and non-position workplace leaders. Facilitator - Sandra Farray*

**Workplace Considerations for People with Autism ..... Fairfield**

*Carol Page describes how people with autism bring unique needs to a work setting. It is important to identify those needs early in the employment process. Some needs will be unique to the individual and other needs will follow some well-known trends for people with autism. Identifying and accommodating these needs often takes a team effort and this can make a dramatic difference in successful work placement. Facilitator - Tom Jackman*

**SC State Library Workforce Resources ..... Saluda**

*Jason Broughton shares how the South Carolina State Library has launched a new website, WorkSC.org to assist libraries, state government agencies, and citizens to locate useful resources on the many facets of workforce development. The site, initially created with libraries and first time job seekers in mind, offers many useful links for beginning as well as seasoned job seekers and can be a great resource in employment of clients. WorkSC.org covers topics such as resume development, job hunting, overcoming barriers, unemployment, and a variety of other workforce tools. Facilitator - Laura Spears*

**Services for Veterans ..... Calhoun**

*Paul Knight and Lori Ehlers provide an overview of the VA's Vocational Rehabilitation & Employment (VR&E) program including their employment services and incentives. An explanation of the similarities and differences between the VR&E program and SCVRD will also be explained with an emphasis on how they can work together. Facilitator - Linda Lieser*

**11:20–12:00 P.M.**

**Concurrent Sessions II (choose one)**

**Leadership Actions that Activate Empowerment and Accountability..... Richland**

*Sheri Callahan identifies the importance of job ownership and how it is the foundation of a happy and well performing team. Guides leaders to promote problem solving, creative thinking, identifies the key steps in meaningful delegation, and how to lead cautious risk taking within guidelines. The issues of leadership trust and control will also be examined. A key session for both positional and non-position workplace leaders. Facilitator - Belinda Langton*

**Understanding Adolescence and Disability ..... Fairfield**

*Robert Dawson discusses mood swings behavioral outbursts, apathy, rule testing, self-esteem issues. Adolescence is both an exciting and challenging time for youth, their parents, and rehabilitation professionals. This presentation looks at the stages of adolescence and what can be considered typical versus atypical behaviors of youth with and without disabilities. Issues of peer pressure, substance abuse, and bullying will be addressed. The presenters will augment current research with examples from their experiences of working with youth. Attendees of this presentation will receive a list of resources to aid them in their work. Assisted by Meredith Cleeton. Facilitator - Ali Cato*

**The Benefit Bank..... Saluda**

*Alicia Jacobs and Tori West explain how the Benefit Bank of South Carolina is a counselor-assisted Internet-based service that helps low and moderate income individuals and families apply for a wide variety of resources that may be available to them such as assistance with food or prescription programs, children’s health insurance, Medicaid, TANF, and many other resources. A program of the S.C. Office of Rural Health, the Benefit Bank now has over 200 active community based sites and 1,200 trained counselors. Participants in this session will learn how Benefit Bank can be helpful in connecting clients and claimants with much-needed resources beyond the scope of VR/DDS services. Facilitator - Margaret Alewine*

**Work Opportunity Tax Credit ..... Calhoun**

*Laura Rushton provides helpful information about the Work Opportunity Tax Credit (WOTC) provided to businesses that hire individuals with barriers to employment. The program enables targeted employees to move from economic dependency into self-sufficiency as they earn a steady income and become contributing taxpayers. Participating businesses receive a reduction in their federal income tax liability as a result of the tax credit. Participants will become more knowledgeable in explaining WOTC to employers when hiring VR clients. Facilitator - Darline Graham*

**NOON–12:15 P.M.**

**Door Prizes..... Congaree B**

**12:15 –12:30 P.M.**

**Break/Visit Exhibit Area..... Congaree B**

**12:30 –2:30 P.M.**

**Awards Luncheon..... Congaree A**

Presiding:

*Mark Wade, Assistant Commissioner*

**Invocation**

*The Rev. John P. Trump, Pastor  
St. Andrews Lutheran Church, Columbia*

**Business Partners Awards**

Presented to: Grainger Distribution Center, Fountain Inn  
Presented by: Dr. Roxzanne Breland, Vice Chair, S.C. State Agency of Vocational Rehabilitation  
Assisted by: David Turnipseed, Greenville Area Supervisor

Presented to: Bridgestone Americas Tire Operations, Aiken  
Presented by: Rhonda Presha, Member, S.C. State Agency of Vocational Rehabilitation  
Assisted by: Jeanette Murray, Aiken Area Supervisor

Presented to: ICE Recycling, LLC, Lake City  
Presented by: Joseph Thomas, Member, S.C. State Agency of Vocational Rehabilitation  
Assisted by: Carol Anderson, Florence Area Supervisor

**Legislative Award**

Presented to: The Honorable G. Murrell Smith Jr., SC House of Representatives, District 67, Sumter  
Presented by: Barbara G. Hollis, SCVRD Commissioner  
Assisted by: Derle A. Lowder Sr., Chairman, SC State Agency of Vocational Rehabilitation and John Hornsby, Sumter Area Supervisor

**Richard Kuffel Excellence in Education Award**

Presented to: Laurens TSS Team/School District 55  
Presented by: Margaret Alewine, Director of Planning

**Commissioner’s Medal of Excellence**

Presented by: Barbara G. Hollis

### 2012 Client Achievement Award

Presented to: Courtney Harper

Presented by: Barbara G. Hollis

Assisted by: Derle A. Lowder, Sr. and Gail E. Murray, Walterboro Area Supervisor

### 2012 Client Achievement Staff Recognition

Presented to: Allison Kitler, Glen Ackerman, Michelle L. Stockman, Walterboro Area

Presented by: Barbara G. Hollis

Assisted by: Derle A. Lowder, Sr. and Gail E. Murray

### Closing Remarks

### Adjournment

## “The Best Source For Assistive Technology”



- Certified Rehab Techs On Staff
- Nationally Accredited
- Factory Trained Technicians

# ALL MEDICAL

2011 Hampton Street, Columbia, SC 29204

## 803.779.2011

**amplify!life**

SCEDP | South Carolina Equipment  
Distribution Program

Administered by the SC School for the Deaf and the Blind

**FREE TELEPHONE & ALERTING DEVICES**

Deaf • Hard of Hearing • Deaf-Blind • Speech  
Impaired or Blind/Low Vision with Hearing Loss

**Contact Our Office for an Application**

**Toll-Free: 1-877-225-8337 Voice**

**Toll-Free: 1-877-889-8337 TTY**

[www.scedp.org](http://www.scedp.org) • [AmplifyLife@scedp.org](mailto:AmplifyLife@scedp.org)

**NORMAN ASMER**

Sales Manager

*email: normsmithjones@aol.com*

## Smith & Jones

Janitorial Supplies & Equipment

Cell: 803-479-8645

Office: 803-822-8500

Toll Free: 866-649-0865

Fax: 803-822-2500

#1 Biloxi Square

West Columbia, SC 29170

[www.smithandjonesjan.com](http://www.smithandjonesjan.com)



## **SC Assistive Technology**

• empower • experience • connect • celebrate •  
• workshops • tools • exhibits •

## **Expo 2013**

---

**Wednesday, March 27, 2013**

**9 am - 4 pm**

**FREE AND OPEN TO THE PUBLIC**

Exhibits and Workshops Showcasing Assistive  
Technology for People of All Ages

**Brookland Banquet and  
Conference Center**

1066 Sunset Boulevard  
West Columbia, S.C. 29169

**EQUIPMENT DONATION DRIVE!**

Bring your used equipment and  
drop it off at the Expo

Get a tax deduction from the  
Disability Action Center

Contact Janet Jendron at  
[janet.jendron@uscmed.sc.edu](mailto:janet.jendron@uscmed.sc.edu)  
or the Disability Action Center at  
803-779-5121

Sponsored by South Carolina Assistive Technology Program, USC School of Medicine Center for Disability Resources, USC SOM Pediatrics, SC Assistive Technology Advisory Committee (Division of State Information Technology), SC Department of Disabilities and Special Needs, Disability Action Center, SC Association for Educational Technology, and Mid-Carolina Area Health Education Consortium

Continuing education application will be made for continuing education credits through Mid-Carolina AHEC , Inc., for Early Intervention credits, and for some sessions to ASHA. Before calling SCATP, please check for updates on continuing education and the Expo at [www.sc.edu/scatp/expo/expo13.html](http://www.sc.edu/scatp/expo/expo13.html). For special accommodations, contact SCATP at [Lydia.durham@uscmed.sc.edu](mailto:Lydia.durham@uscmed.sc.edu) , call 1-800-915-4522 or 803-935 5263 by March 15, 2013





**Teddy Calcina, III**, CHFC, CLU  
Investment Adviser Representative

Office (803) 799-9267  
Cell (803) 360-7293  
Fax (803) 799-5039

Calcina Agency, Inc  
P.O. Box 11617  
Columbia, SC 29211  
tcalcina@woodburyfinancial.net  
TeddyCalcina.com

Securities and Investment Advisory Services offered through Woodbury Financial Services, Inc., Member FINRA, SIPC and Registered Investment Adviser.

Calcina Agency, Inc and Woodbury Financial Services, Inc. are not affiliated entities.

---

Woodbury Financial Services, Inc.

P.O. Box 64284

St. Paul, MN 55164

(800) 800-2638

# Speakers



**Sheri Callahan** now calls home Columbia, South Carolina, but still embraces the memories of her original home of Southern California. As a proud graduate of the University of South Carolina and Columbia College, Sheri brings a Bachelor's in Speech Communication and a Master's in Human Behavior and Conflict Management to her work in professional development. Sheri

values education and strives to build upon her professional and personal growth. Sheri brings 16 years of experience in workplace performance, team dynamics, vital interpersonal training, conflict mediation, leadership coaching, and motivational keynotes. Sheri finds deep value in her work as she and clients find practical solutions to the frustrating obstacles of the workplace. She is an avid supporter of volunteerism and draws unique strength from assisting others in identifying and tackling their career and professional development goals. Horizon Consulting Group maintains clients across all industry lines both domestically and internationally.



**Alicia Jacobs** served over 35 years in State Government with the SC Department of Social Services and the South Carolina Department of Health and Human Services in areas of Food Stamp, TANF and Medicaid eligibility, quality control, training and development of policy and procedure. She has an Associate Degree in Human Services. Starting as a front line intake worker in 1974, she has a multifaceted

perspective of Human Services at the county, regional and State Office levels. She finished her career with the Medicaid agency as the Deputy Director for Medicaid Eligibility and Beneficiary Services. Alicia currently serves as the Director of the Health eConnections CHIPRA Grant, awarded to the Benefit Bank of South Carolina. The Benefit Bank is a program of the South Carolina Office of Rural Health. Her focus is on enrolling uninsured children in Medicaid.



**Carol Page, PhD, CCC-SLP, ATP** is the Program Director of the South Carolina Assistive Technology Program (SCATP) at the USC School of Medicine, Center for Disability Resources, Department of Pediatrics. Dr. Page promotes and coordinates activities of the SC Assistive Technology Program including training, device loan, device demonstration,

device reuse, public awareness, and technical assistance with other agencies. She supervises and mentors students from speech-language pathology masters and undergraduate programs who perform tasks of the device loan and demonstration programs. Dr. Page provides trainings at local, state and national levels on assistive technology for persons with disabilities of all ages, their caregivers and professionals who serve them.



**Tori West** studied Biology concentrating in Pharmaceutical and Biomedical Sciences at the University of South Carolina and College of Charleston. Tori has over 10 years of professional and volunteer work experience. She completed one year of service with TBB-SC as an Americorps VISTA. Prior to her domestic service, Tori worked for 5 years with the Department

of Health and Environmental Control in Site Assessment and Remediation as a Natural Resource Technician before relocating to Charleston, SC.



**Jason Broughton** is the Workforce Development Trainer & Outreach Coordinator for the State Library, has a master's degree in Public Administration, and assists libraries, state government agencies and employees, and citizens locate useful

resources on the many facets of workforce development.

**Laura Rushton** has been employed with the South Carolina Department of Employment and Workforce for 23 years. Much of her career has been spent working in programs geared towards helping individuals with barriers to employment become gainfully employed. Such programs include the Job Training Partnership Act (JTPA) and the Targeted Jobs Tax Credit Program (TJTC). Laura currently serves as the Work Opportunity Tax Credit (WOTC) Coordinator for the state of South Carolina, following a 12 year tenure in the program educating businesses and service providers about WOTC and providing certification to WOTC-friendly businesses in our state.

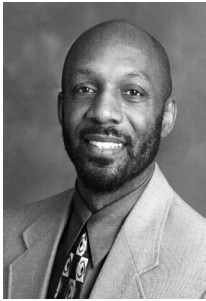

**Carl R. Wells, PhD**, is the Assistant Director of the Office of Equal Opportunity Programs at the University of South Carolina. Dr. Wells is responsible for investigating allegations of discrimination and harassment. Dr. Wells has more than 18 years' experience as a trainer, facilitator, and investigator. Prior to his tenure with the Office of Equal Opportunity Programs, Dr. Wells served

as the University's Director of Multicultural Student Affairs for 5 years and the Assistant Dean of Students at Lander University in Greenwood, South Carolina for 6 years. Dr. Wells is also responsible for providing training and education to University search committees in regard to best practices for hiring diversity. In addition, Dr. Wells directs the office's assessments/evaluation initiatives and chairs the University-wide Martin Luther King, Jr. Commemorative Celebration Committee. Dr. Wells is also responsible for managing the Office's budget and coordinating campus-wide diversity education initiatives. Additionally, he often serves as consultant for both the public and private sector. He received his undergraduate degree from Winthrop University, his master's degree from Emory University and his Ph.D. from the University of South Carolina.



**Dr. Paul Knight** has been providing rehabilitation services to persons with disabilities for over 40 years. After graduating from The University of Tennessee, he began his career with the South Carolina Vocational Rehabilitation Department. He retired from SCVRD in 1997, to accept a position with the Region IV Rehabilitation Services (RSA)

in Atlanta. He worked as a State Representative Program Administrator for RSA until 2000 when he accepted employment with the Veteran Affairs Department in Columbia. In 2002 he accepted a position in the Department of Veteran Affairs Central Office in Washington, DC. He returned to Columbia in 2004 when he accepted the position as Assistant Vocational Rehabilitation and Employment Division Chief.



**Lori Ehlers** has been providing employment services to persons with disabilities for over 20 years. After graduating from Old Dominion University, she began her career with the Virginia Department of Rehabilitative Services. She then worked for a federally funded grant program, a non-profit organization,

and a government contractor, all within the field of Employment and Vocational Rehabilitation. Lori has been an Employment Coordinator with the VA's Vocational Rehabilitation & Employment (VR&E) program since the creation of the position in 1999. She started her career with the VA's VR&E program in the Hampton Roads, Virginia area. She relocated to South Carolina in the same position in 2006. Since that time, she has built strong employment partnerships throughout the state of South Carolina and created many employment opportunities for the disabled Veterans in the VR&E program. Her specialty areas are the non-competitive employment placements of Veterans into federal positions, the VA's Non-Paid Work Experience (NPWE) program and assisting with training for the VR&E, Employment Services program nationally.



**Robert "David" Dawson, PhD, CRC**, began his training as a rehabilitation counselor in 1981 at Appalachian State University and for 30 years has been continuously working and learning about rehabilitation. David is currently a Clinical Assistant Professor in the Rehabilitation Program at the University of South Carolina School of Medicine. Prior to the University of

South Carolina he was a faculty member at Winston-Salem State University graduate and undergraduate program, Director for the Iowa Center for Assistive Technology and Educational Resources, Senior Researcher for the Law, Health Policy, and Disability Center at the University of Iowa, and Vocational Rehabilitation Counselor for the State of Florida. Areas of expertise include assistive technology, transitions counseling, traumatic brain injury, and technology for education. One of his computer training programs was developed to help students understand and perform job analysis. Since that time it has been used by thousands of persons from almost every continent and is a standard training tool for several vocational rehabilitation organizations. Currently, the program is free for anyone to use through the Internet. [http://disability.law.uiowa.edu/itworks/online\\_ed/index.htm](http://disability.law.uiowa.edu/itworks/online_ed/index.htm)

# Exhibitors & Sponsors

*Platinum Sponsors*  
Calcina Agency

*Platinum Break Sponsor*  
North American Rescue

*Gold Sponsors*  
Allied Opportunities, Inc.  
Carolina Mobility Sales, LLC

*Silver Break Sponsor*  
Reliable Medical Equipment  
of South Carolina

*Bronze Sponsors*  
All-Medical  
Med Emporium  
S.C. Assistive Technology Program  
S.C. Equipment Distribution Program  
S.C. State Employee Association  
Smith & Jones

*Silver Break Sponsor*  
Sonoco Products

*Bronze Break Sponsor*  
Med Emporium

*Exhibitors*  
S.C. State Library  
Walgreens

## Door Prize Donors

Adluh  
Ashland Chemicals  
Atsko  
BI-LO  
Carolina's Harvest  
Caroline's Cake  
CEJN Industrial  
Corporate Concepts, Inc.  
CPE  
Derle A. Lowder Sr.  
Dread Head H.Q.  
Edwards Enterprise  
Forms & Supply, Inc.  
Geiger  
Hyman Paper & Chemical Co.  
Intertape Polymer Group  
Jarden Applied Materials  
Johnson Brothers  
Kaplan Early Learning Co.

KMH Interiors  
Kuriyama of America  
LeCreuset  
Lillie Bolden  
Low Country Stores  
McClancy Seasoning  
Pontiac Foods  
Outdoor Hands  
Rico Tag Industries  
S.C. Department of Parks,  
Recreation, and Tourism  
Sexton Dental Clinic  
Smitty's Printing  
Sonoco  
State Farm Insurance  
Stee-Rike 3 Inc.  
Tideland Utilities, Inc.  
Tupperware  
Walgreens  
Zeus

**MED**   
*emporium*

# *Enhancing the Quality of Life*



## **THREE EMPOWERING PROGRAMS**

### **Loan Programs**

- \* Assistive Technology Loans
- \* WorkABILITY Loans
- \* Mobility Vehicle Loans
- \* Adaptive Equipment Loans
- \* Home Modification Loans
- \* Business Loans
- \* Low-Interest Rates

### **Employment Program**

- \* Offers assistance toward independence through employment
- \* Placement of dependable and pre-screened workers
- \* Referral Source for SCVRD
- \* Develops employment opportunities throughout South Carolina
- \* Partners with NISH, SCVRD, & private business industry

### **Veteran's Affairs Program**

- \* Vocational Assessments
- \* Evaluation Assessments
- \* Partners with Vocational Rehabilitation
- \* Prepares Veterans with Job Readiness Training

---

**Preston Coleman**  
Director

**Tiffany T. Hewett**  
Loan Program Manager  
Direct: (803) 726-7143  
Fax: (803) 822-8948  
Email: [THewett@AlliedInc.net](mailto:THewett@AlliedInc.net)

**Kristin Driggers**  
Program Manager  
Direct: (803) 726-7141  
Fax: (803) 822-8948  
Email: [KDriggers@AlliedInc.net](mailto:KDriggers@AlliedInc.net)

**Lucerne Iseman, M.Ed.**  
Assessment Specialist  
Direct: (803) 896- 6579  
Fax: (803) 822-8948  
Email: [LIseman@scvrd.state.sc.us](mailto:LIseman@scvrd.state.sc.us)

# Around the State: Local Client Achievement Award Winners

## AIKEN



*(l to r, back row) Jerlyn Lee, Darlene Conley, and Angela McGhee, (l to r, front row) Debra Carlin and Patti Mims. Not pictured, Cynthia Ferguson.*

## ANDERSON



*(l to r) Melissa Smith, Thomas Pounds, Margaret Norryce, Stormy Avery, client: Doug Horton, Anne McAuley, Sheila Ford, and Wendy Johnson. Not pictured, Garvin Greer, Jennifer Porth, Lillie Bolden.*

## BEAUFORT



*(l to r) John Gallagher, Christine Whiteleather, Heather Steele, and Gregg Gilbert.*

## BERKELEY-DORCHESTER



*(l to r) Sharkea Hicks, Nancy Mitchum, Elaine Ellington, Renita Smith. Not pictured and Todd Batt.*

## BRYANT CENTER



*(l to r) Tanya Lambert, Jonathan Cruce, Sherry Waddell, Kenneth Tuckmantel, Norma Grizzard, Jennifer Spears, Adult Ed Teacher; Jennie Thomas, Silvia Petracich, and Ward Gray.*

## CAMDEN



*(l to r) Patrick Pellicer, Arnetha Cave, Stacy Lever, Robbie Truesdale, Leroy Nixon, and Brian Green.*

# Around the State: Local Client Achievement Award Winners

## CHARLESTON



*(l to r) Sherry Slaughter, client; Warren Helm, Cathy Clower, and Shannon Reed*

## CONWAY



*(l to r) Keith Rabon, Mark Conley, Steve Suggs, and Michael Johnson.*

## FLORENCE

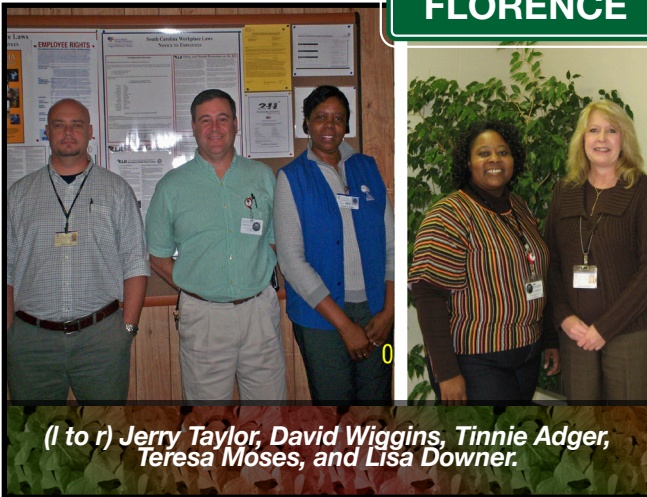

*(l to r) Jerry Taylor, David Wiggins, Tinnie Adger, Teresa Moses, and Lisa Downer.*

## GREENVILLE



*(l to r) Kerry Reece, Vaneasha Danzy, Tammy Galindo, Dionne Allen, and Rick Poole.*

## GREENWOOD



*(l to r) Susan Harris, Michael Shea, Client; Leslie Leary, Employer Representative (St. Marks Methodist Church). Not pictured, Tammy Johnson, Jonathon Cruce.*

## LAURENS



*(l to r) Chad Ulmer, Dale Pressley, Client; Gloria Patrick, Tim Gary, and Donnie Estes.*



## MARLBORO



*(l to r) Terry Boyles, Latonda Abraham, Shelia Gilbert, Diane Smith, and Tillette Scott.*

## ORANGEBURG



*(l to r) Brandi Knight, Bessie Dowling, Retired Counselor; Kitty Bamberg, and Willie Mae Goodwin.*

## RICHLAND



*(l to r) Stephen Marshall, Brenda Winter, Nicole Troutman, and Ike McAlhany.*

## ROCK HILL



*(l to r) Leslie Crenshaw, Veneka Jasper, Joanne Bowers, Adult Ed Instructor for WorkKeys; and Tina Stuber.*

## SPARTANBURG



*(l to r) Tim Geter, Leigh Ann Caudill, LaRonda Frye, Dana Rolin, and Patrick Wentz.*

## SUMTER



*(l to r) Angela Sumpter, Michael Dinkins, client; and Jeryl Jacobs.*

# Carolina Mobility Sales

*"Customers for Life"*

## Handicap Vehicles - Van Conversions

- Personal wheelchair lifts & driving equipment
- Commercial wheelchair transport vehicles
- Handicap home equipment & modifications
- New & used handicap vans for sale or lease
- Commercial & business use van conversions
- Insurance repair & used conversion refurbishing

*Imagine the Possibilities*



**"The 2009 Toyota Sienna  
with Braun lowered floor Ramp Van Conversion"**



## Carolina Mobility Sales

2546 Leaphart Road, W. Columbia, SC 29169  
Columbia, SC

803-791-7791 - 866-826-5438

[www.cmobilitysales.com](http://www.cmobilitysales.com)

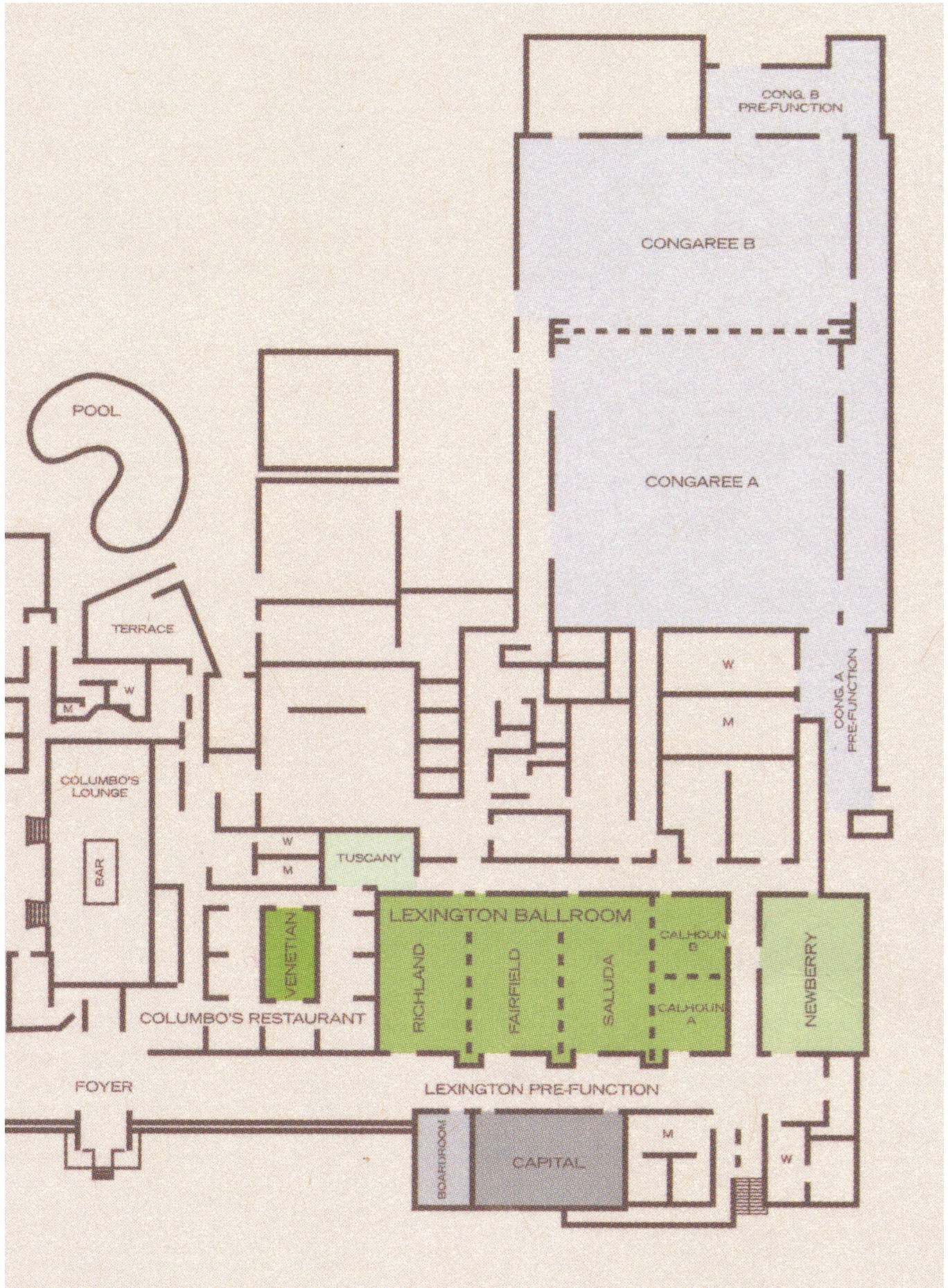

PRODUCTS  
with a *MISSION*<sup>®</sup>



*Empowering the Unsung Heroes of First-Response Casualty Care with the Innovative Medical & Rescue Equipment Critical to Saving Lives on the Battlefield...*



**NORTH AMERICAN RESCUE<sup>®</sup>**

[www.NARescue.com](http://www.NARescue.com) • 888.689.6277

*PROUD PARTNERS in EMPOWERMENT with the SCVRA*