



Making  
a  
Difference

SCVRA Annual Meeting  
Myrtle Beach • October 18-20, 2017



**PRODUCTS**  
WITH A  
**MISSION®**



**NORTH AMERICAN RESCUE®**

[www.NARescue.com](http://www.NARescue.com) • 888.689.6277

Empowering the Unsung Heroes of **First-Response Casualty Care** with the **Innovative Medical & Rescue Equipment** Critical to **Saving Lives** on the Battlefield...

PROUD PARTNERS in EMPOWERMENT with the SCVRA

# Schedule

## Wednesday, October 18, 2017

**3:00 - 4:00 pm**

**Exhibitors Setup**

**Cambridge Hall**

**4:00 - 5:00 pm**

**Registration & Visit Exhibit Area**

**Cambridge Hall**

**5:00 - 5:30 pm**

**SCVRA Business Meeting**

**Kensington A-C**

Division Reports

Election of Officers

New Business

**6:30 - 10:00 pm**

**Dinner Reception & Karaoke**

**Palmettos Pavilion**

## Thursday, October 19, 2017

**8:00 - 9:00 am**

**Registration & Visit Exhibit Area**

**Cambridge Hall**

**9:00 - 10:00 am**

**General Session**

**Kensington D-G**

*Welcome*

David Edwards, President, SCVRA

*Presiding*

Mark Wade, Assistant Commissioner, SCVRD

*Color Guard*

Carolina Forest High School Navy JROTC

*National Anthem*

Alton Johnson, JRT Training Coordinator, SCVRD

*Guest Speaker*

Curt Thomas, "Bringing Out the Greatest You"

**10:00 - 10:30 am**

**Break / Visit Exhibit Area / Door Prizes**

**Cambridge Hall**

**10:30 - 11:30 am**

**Concurrent Sessions (choose one)**

**Employer Forum**

**Eton**

What are employers looking for, and how can VR professionals maximize opportunities in helping them meet their workforce needs? A panel of Grand Strand area human resource managers and business representatives share their thoughts at this session, including Heather Jordan, Director of Human Resources for Founders Group International, Stephanie Sebring, Recruiting Coordinator for the City of Myrtle Beach, Verlon Wulf, President of Carolina Cool, Inc., Ms. Linda Seeger, HR Manager for the Law Offices of McCutchen, Mumford, Vaught, and Geddie and Melissa Bilks, Director of Human Services, Brittain Resorts.

**Pragmatic Language**

**Winchester**

Kelly Kampwerth

Pragmatics refers to the social language skills we use in our daily interactions with others. They include what we say, how we say it, our body language and whether it is appropriate to the given situation. Pragmatic skills are vital for communicating our personal thoughts, ideas and feelings. Attendees will learn how these skills can help in service provision, documentation, and professional relationships.

**Utilizing Assistive Technology to Assist Individuals with Autism Spectrum Disorder**

**Somerset**

Bradley Crain and Valeska Gioia

This workshop will provide attendees with an understanding of what Autism Spectrum Disorder is and what assistive technologies can be used to assist our clients who are on the spectrum. We will focus on the strengths and functional limitations that individuals with autism face in education and in their vocation. Some of the topics that we will go over are Sensory Processing, Executive Functioning, socialization, and communication.

**Employee Engagement in the Millennial Era**

**Windsor A**

John Rouda

Millennials have brought new perspectives and approaches to the workplace and our communities. This session focuses on how to create an environment of engagement and leadership as generations work.

**11:30 am - 12:00 pm**

**Break / Visit Exhibit Area**

**Cambridge Hall**

**12:00 - 1:45 pm**

**Luncheon Recognizing Business and Industry**

**Kensington**

*Presiding*

David Edwards

*Invocation*

Reverend Michael Burgess, Pastor

Singleton Chapel AME Church, Georgetown

**Divisional Awards**

*Administrator of the Year Award*

Presented by: John Sandifer

President, SC Vocational Rehabilitation Administrators Association (SCVRAA)

*Direct Client Service Award*  
Presented by: Carolee Dunn  
President, Direct Client Service Division (DCSD)

*Barry Cooper Leadership Award*  
Presented by: Erica Amorim  
President, SC Association of Disability Evaluation Specialists (SCADES)

*Technical Services Award*  
Presented by: Niki Outen, President  
Technical Services Association (TSA)

*Professional Staff Award*  
Presented by: Leola Evans  
Vice President, Professional Staff Association (PSA)

### **Business Partnership Awards**

*Upstate Region*  
AnMed Health, Anderson  
Presented by: Rev. Timothy W. Evatt, Esq.  
Board Member, SC State Agency of Vocational Rehabilitation  
Assisted by: Lisa Gillespie  
Supervisor, Anderson Area Office

*Midlands Region*  
Roy's Wood Products, Lugoff  
Presented by: Rhonda J. Presha  
Board Vice Chair, SC State Agency of Vocational Rehabilitation  
Assisted by: Summer Rigby  
Supervisor, Camden Area Office

*Lowcountry Region*  
Worksman Cycles, Conway  
Presented by: Joseph A. Thomas  
Board Member, SC State Agency of Vocational Rehabilitation  
Assisted by: Tania Appel  
Business Development Specialist, Conway

*Exemplary Employer Award*  
Ruiz Food Products Inc., Florence  
Presented by: Dr. Roxzanne Breland  
Board Chair, SC State Agency of Vocational Rehabilitation  
Assisted by: Pam Company  
Supervisor, Florence Area  
Office

 **ANMED HEALTH**  
We're in this together.

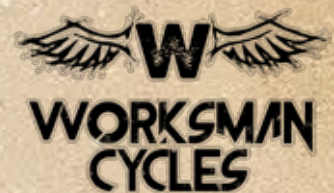

**1:45 - 2:00 pm**  
**Break**

**2:00 - 3:00 pm**

**Concurrent Sessions (choose one)**

**Mindfulness at Work**

**Eton**

Dr. Elva Stinson and Teri Norris

We need tools to help us maintain focus, attention, and calm at work. Mindfulness is an ancient technique that can help us become more effective, collaborative, relaxed and kind. This session will explore the science, benefits, and practice of mindfulness, and will offer ways to incorporate it into your daily work life.

**Understanding Diabetes**

**Somerset**

*Speaker TBA*

Diabetes is prevalent in South Carolina's population and is often an impediment to employment. Learn about the many aspects of diabetes and how we can assist individuals in understanding and addressing it as they seek their vocational goals.

**Stop! Collaborate & Listen!**

**Windsor A**

***Transition's Back at a Brand New Convention***

Deirdre Cato

Come join the fun and learn how local interagency teams are collaborating and providing pre-employment transition services to the students they serve by using best practices and strategies. The Horry County WAVES (Conway Area staff members Michelle Hudson, Amanda Butler and Sandy Johnson, and Jackie Bryant, Coordinator of Horry County Office Special Education), and Florence County FloGo1 (Florence area staff members Xavier Sams, Shainna Williams and Erica Frye) will provide creative ideas and activities that participants can replicate with their own local teams.

**When Perspectives Clash**

**Winchester**

Dr. Kenneth R. Norris

This presentation explores how our unique personalities, work and family dynamics, and individual perspectives create an often undetected layer of complexity within our daily interactions. The session will offer practical tips for recognizing and diffusing conflicting perspectives before they become adversarial or destructive.

**3:00 - 3:15 pm**

**Break / Visit Exhibit Area**

**Cambridge Hall**

**3:15 - 4:00 pm**

**Division Meetings**

SC Association of Disability Evaluation Specialists  
Administrators' Association  
Technical Services Association  
Direct Client Services Division

**Eton  
Winchester  
Somerset  
Windsor A**

**4:00 - 4:30 pm**

**Visit Exhibit Area / Door Prizes**

**Cambridge Hall**

**Thursday Night Social**

**On Your Own (see flyer in program)**

Friday, October 20, 2017

8:30 - 9:00 am

Registration & Visit Exhibit Area

Cambridge Hall

9:00 - 10:00 am

General Session

Kensington D-G

*Welcome*

Mark Wade

*Guest Speaker*

Scott Burrows, "Vision, Mindset and Grit"

10:00 - 10:30 am

Break / Visit Exhibit Area / Door Prizes

Cambridge Hall

10:30 - 11:30 am

General Session

Kensington A-C

*Presiding*

David Edwards

*Guest Speaker*

Larry Weaver, "Lessons Learned Through Laughter"

11:30 am - 12:00w pm

Break / Visit Exhibit Area / Door Prizes

Cambridge Hall

**"The Best Source For Assistive Technology"**



- Certified Rehab Techs On Staff
- Nationally Accredited
- Factory Trained Technicians

**ALL  
MEDICAL**

2011 Hampton Street, Columbia, SC 29204

**803.779.2011**

**12:00 - 1:45 pm**  
**Awards Luncheon**

**Kensington D-G**

*Presiding*  
Mark Wade

*Invocation*  
Deacon Richard Flenke  
Our Lady Star of the Sea Catholic Church, N. Myrtle Beach

*Richard M. Kuffel Excellence in Education Award*  
Presented to: Pat G. Smith, Director, Wil Lou Gray Opportunity School, West Columbia  
Presented by: Laura Spears, Transition Services Coordinator, SCVRD

*DDS Director's Award*  
Presented by: Shirley W. Jarrett, Director, Disability Determination Services

*2017 Client Achievement Award*  
Presented to: Simon Castaneda  
Presented by: Felicia W. Johnson, Interim Commissioner, SCVRD  
Assisted by: Dr. Roxzanne Breland, Chair, SC State Agency of Vocational Rehabilitation, and Kelly Sieling, Supervisor, Berkeley-Dorchester Area Office

*2017 Client Achievement Staff Recognition*  
Kim van Deusen, Administrative Team Support Specialist, Berkeley-Dorchester Area  
Michelle McDonald, Business Development Specialist, Berkeley-Dorchester Area  
Rob Wiggins, Center Manager, Berkeley-Dorchester Area  
Loleta Ravenell, Job Readiness Training Associate, Berkeley-Dorchester Area  
Richard Kelly, Job Readiness Training Associate, Berkeley-Dorchester Area  
Wendy May, Job Preparedness Instructor, Berkeley-Dorchester Area  
Lorna Manglona-Alexander, Career Specialist, Berkeley County School District  
(former VR Counselor)

*Closing Remarks*  
Mark Wade

*Adjournment*

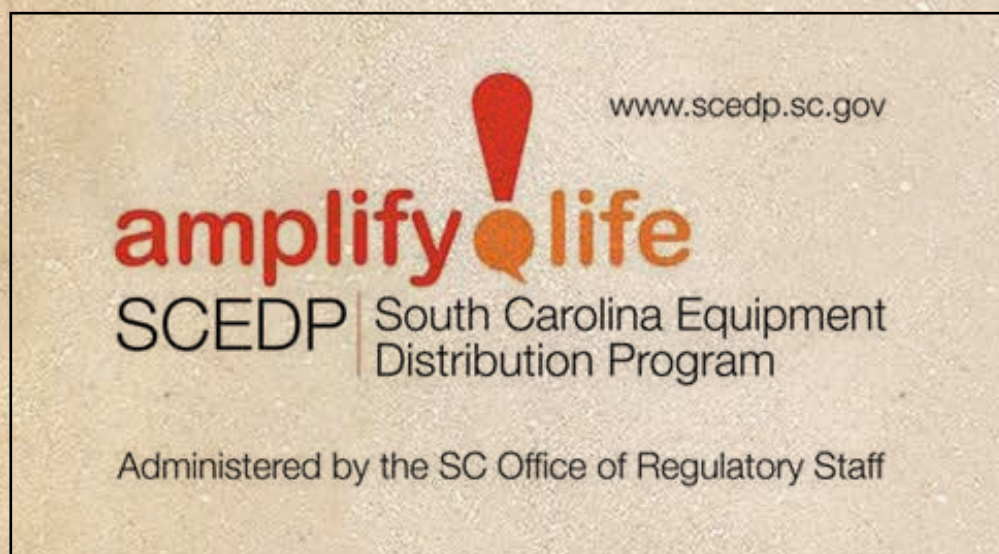



## About the Kuffel and Cooper Awards

The Richard M. Kuffel Excellence in Education Award honors the dedication and passionate leadership of the late Richard Kuffel, who as a VR employee was instrumental in developing school-to-work transition services across South Carolina. He had tremendous knowledge and foresight to see the importance of collaboration between VR and the local school districts, higher education and other education partners.

The Barry Cooper Leadership Award is dedicated to the legacy of leadership and service of the late Barry Cooper. As an examiner with VR's Disability Determination Services he demonstrated exemplary adjudicative skills. As a supervisor, he remained a team player and served as a mentor to many new examiners. As a co-worker, he exhibited an unwavering positive attitude. Barry was a founding member of the South Carolina Association of Disability Evaluation Specialists.



**Calcina Agency**  
Incorporated

**Financial Planning  
&**

**Wealth Management**

Teddy Calcina, III, CHFC, CLU

**803-939-0333**

# Speakers



**Scott Burrows:** Scott Burrows is living proof your life can change in an instant. By the age of 19, he was playing football for Florida State University and a top-ranked kick-boxing champion. On November 3, 1984, he was involved in a serious automobile accident that left him paralyzed from the chest down and diagnosed as quadriplegic. Despite his grim prognosis, Scott refused to be sidelined. With singular focus, he boosted his recovery by using the innovative principles of Vision, Mindset and Grit. Employing his paralysis as a visual metaphor, Scott encourages audiences worldwide to stand up to their challenges—regardless of circumstances.



**Deirdre Cato:** Deirdre began working with SCVRD in 2008 as a Transition Counselor and most recently has served as a Transition Specialist in our state office. Prior to this, she worked as a teacher and Guidance Counselor in Chesterfield County School District for 15 years where she spent 9 years working with at-risk youth in an alternative school setting. Throughout this time, she found that community collaboration was the key to helping students remain in school and move toward positive graduation and career outcomes.



**Bradley E. Crain:** Bradley Crain is a Rehabilitation Engineer Assistant for SCVRD's Rehabilitation Technology unit. Bradley has previously worked as an Assistive Technology Coordinator for the University of South Carolina. He has presented throughout South Carolina on the benefits of using assistive technologies and is fluent in American Sign Language (ASL). Bradley received his bachelor's degree in Sociology from the University of South Carolina. He is currently pursuing his Master's degree in Rehabilitation Counseling from the University of South Carolina School of Medicine. Bradley has served for the past 3 years as a communications chair for SCAHEAD (South Carolina Association on Higher Education and Disability).



**Valeska N. Gioia Ed.S., ATP:** Valeska Gioia is an Educational/Assistive Technology Specialist and Autism Consultant for SCVRD's Rehabilitation Technology unit. Valeska has previously worked as an Assistive Technology Specialist for the SC Department of Education and was Vice President of Educational Services at the SC Autism Society. Valeska conducts presentations throughout the state on various technologies that can improve student performance in all academic and vocational areas. Valeska has also presented nationally at ATIA, Closing the Gap, and The Council for Exceptional Children and she has also presented internationally for Microsoft.



**Kelly Kampwerth, M.A., CCC-SLP:** Kelly has been a speech language pathologist for 21 years, serving clients in the public schools, home health, hospital, and private settings. She joined DDS in March 2017 as a medical advisor. Kelly is originally from St. Louis, Missouri and moved to Charleston, SC in 2006 with her husband and three daughters. Kelly's special areas of interest include autism, assistive technology, and pediatric speech language disorders.



**Dr. Kenneth R. Norris:** Dr. Kenneth R. Norris – DDS Deputy Director for Administrative Services holds a doctorate from the Southern Baptist Theological Seminary in Psychology of Religion, with post-doctoral clinical training at the University Hospital in Augusta, Ga. He holds M.B.P.I Step I and II certification and has taught Dynamics of Interpersonal Conflict for SCVRD General Program supervisors, multiple leadership levels at the DDS and for the Social Security Administration Atlanta Region. He serves as a Chairperson on the SC State Employee Grievance Committee, a mediator on the SC Alternative Dispute Resolution Statewide Mediators Pool, and is a member of the National Association for Conflict Resolution. He is author of “A Tale of Two Perspectives: Dynamics of Interpersonal Conflict from a Christian Point of View.”

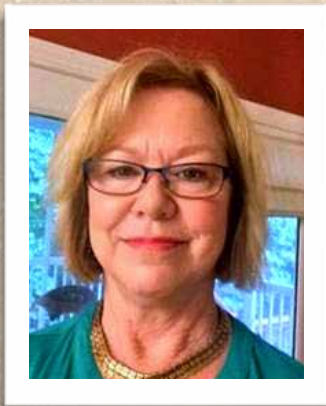

**Teri Norris:** Teri Norris has over 15 years of training delivery, leadership and development experience with the DDS and the SCVRD Human Resources Development Department. Recently promoted to Training and Development Director, Teri believes that adults need a comfortable, interactive environment if they are to learn the skills and attitudes necessary for achieving their potential. Her background in DDS claims adjudication (SC, Florida, and Texas) and years of social work experience, serving elderly and disabled adults, demonstrate a diverse professional background. Whether teaching customer service skills, True Colors, team building or time management, Teri has always believed in the power of choosing your attitude. Developing a deeper interest in Mindfulness, after personally experiencing its benefits, she pursued additional training to better understand its effectiveness and practical use in the workplace.



**John Rouda:** John Rouda leads an IT Department in the Charlotte, NC area. He also teaches Digital Information Design and Computer Science at both Winthrop University and York Technical College, bringing this background in technology and engagement with millennials to his concurrent session at SCVRA. John regularly speaks at conferences, including a TEDx talk on creative leadership. He has written 3 books and currently hosts the podcast, A Geek Leader, which can be found on iTunes or at <http://ageekleader.com/>. To learn more about John visit <http://johnrouda.com>.



**Dr. Elva Stinson:** Elva Stinson, MD, graduated from the University of South Carolina Summa Cum Laude with a B.S. in Biology. She obtained her medical degree from the Medical University of South Carolina and completed a residency in Emergency Medicine at the University of South Carolina School of Medicine. She began working with the SC Disability Determination Services in 2005 at the Columbia Regional Office after a brief stint with the agency in the early 1990s. She has been in her current position in the SC DDS Administrative office as Senior Medical Consultant since 2012 where she serves as medical liaison for the Administrative Office, provides feedback and training for community providers, assists in quality control, and interviews and trains new medical consultants.



**Curt Thomas:** Curt Thomas is national and state motivational speaker. Curt is a former a State Trooper of nearly seven years with the South Carolina Highway Patrol. During that time Curt starred in several TV commercials, escorted professional golfers and traveled around the nation with a university football team. Today, Curt is an entrepreneur and the owner of Curt Thomas Unlimited, LLC. Curt also serves the country as a Reservist in the United States Air Force. He is a graduate of Carolina Theological Bible Institute, Claflin University, Buckley's School of Public Speaking and The Les Brown Speaker Development Training Course. Curt is also a member of the National Speakers Association and a Founding Member of the Les Brown Institute. He is a member of The National Society of Leadership and Success, The Golden Key International Honor Society and Kappa Alpha Psi Fraternity, Inc.



**Larry Weaver:** Larry Weaver is an entrepreneur, author and professional comedian. He grew up in the rural village of Saxapahaw, NC, and started performing at a young age. After majoring in accounting at the University of North Carolina, Larry left his CPA dreams behind to tour across America as a stand-up comedian. Over the past 25 years, he has headlined thousands of performances in 38 states, sharing the stage with entertainment legends like Faith Hill, Chris Rock and "Weird Al" Yankovic. An early expert in Search Engine Marketing and Ecommerce, his business insights have been quoted in Inc. Magazine and the Wall Street Journal. Through the website FunAwards.com he sells an original line of corporate awards in over 60 countries worldwide, from Mozambique to Malta. You can hear him daily on Sirius XM radio's "Laugh USA" and "Great American Comedy." You'll laugh, learn, and leave feeling refreshed!



# 3 Reasons why benefit administrators in government choose Colonial Life

- Market expertise
- Dedicated service
- New ways to save money

## To learn more, contact:

**Tyrone Gainey**

803-422-6409

[Tyrone.Gainey@ColonialLife.com](mailto:Tyrone.Gainey@ColonialLife.com)

**Ian Schumpert**

803-271-9190

[Ian.Schumpert@ColonialLife.com](mailto:Ian.Schumpert@ColonialLife.com)

[ColonialLife.com](http://ColonialLife.com)

DISABILITY ■ ACCIDENT ■ LIFE ■ DENTAL  
CRITICAL ILLNESS ■ HOSPITAL INDEMNITY

**Colonial Life**<sup>®</sup>  
The benefits of good hard work.<sup>®</sup>

# Map

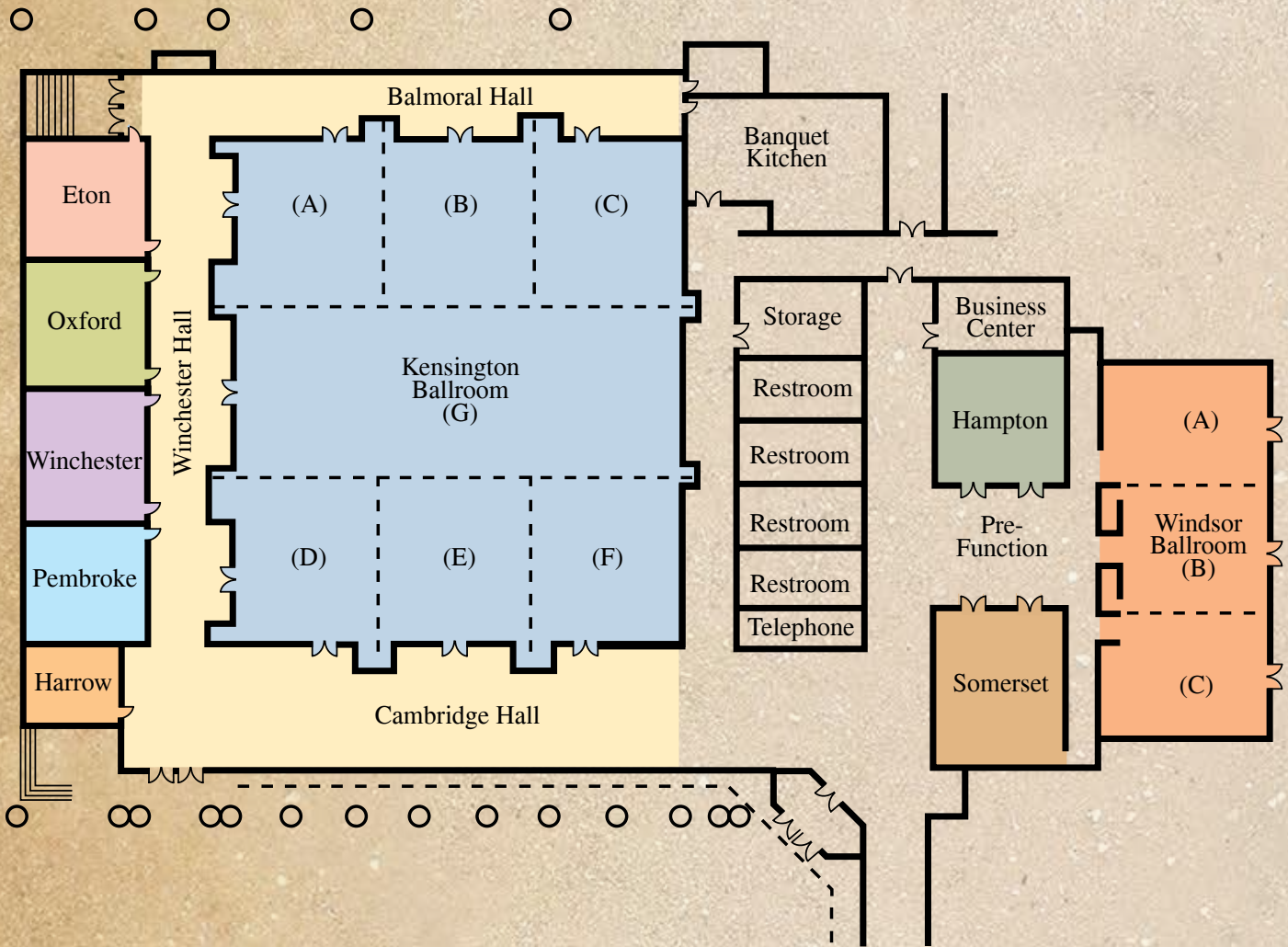

# Statewide Client Achievement Award

## Berkeley-Dorchester



(l to r) Loleta Ravenell, Kim Van Deusen, Loma Manglona-Alexander, Simon Castaneda (client), Richard Kelly, Michelle McDonald, Robert Wiggins

### South Carolina State Employees Association (SCSEA)



The South Carolina State Employees Association started in 1943, when a group of 20 state workers wanted to establish a state retirement system. In 1946 the South Carolina State Employees Association was officially chartered in 1946. SCSEA is a non-profit, non-partisan organization established to advance the welfare of state employees and retirees.

SCSEA focuses on retirement increases, pay, a state grievance procedure, the state-supported health insurance plan, the dental insurance plan, improvements in leave, and retirement with full benefits.

Membership is open to all active employees and retirees of South Carolina state departments, agencies, and institutions. Many payment options are available including payroll and retirement deductions, credit card, check, or money order.

We offer a variety of discounts for all SCSEA members. For more information visit [www.scsea.com](http://www.scsea.com).

421 Zimalcrest Drive, Suite 302, Columbia, South Carolina 29210

EMAIL: [SCSEA@scsea.com](mailto:SCSEA@scsea.com)

PHONE: (803) 765-0680

FAX: (803) 779-6558

# Local Client Achievement Awards

## Aiken



(l to r, b to f) Teniqua Nance, Shayla Padgett, Melissa Hildebrand, Dorothy Quade (Supervisor, Aramark), Amber Davenport (client)

## Anderson



(l to r) Jason Burriss (client), Whitney Smith

## Beaufort



(l to r) Joycestean Pringle, Kyle Githrie (client), Christy Jinks

## Camden



(l to r) Jamison McClam, Shakeima Montgomery, Keywan Mayo (client), Brian Green

## Charleston



(l to r, b to f) Michelle Haymaker, Phy Blake, Rhonda Cummings, Shannon Reed, Joy Gordon (client)

## Conway



(l to r) Ray Singleton, Windy Nave (client), Terry Alston, Tania Appel



## Florence



(l to r, t to b) Freddie Evans (client), Dennis Beckley (Operations Manager, Ruiz Foods), Kenneth Feagins, Sandra Williams, Tameka Williams, Patrick Williamson

## Gaffney



(l to r, b to f) Rick Gray (Dir. of Resident Care, Magnolia's of Gaffney), Mica Duncan, Helen Pirkey, Kelly Koester, (Exec. Dir., Magnolia's of Gaffney), Michael Leach (client)

## Greenville



(l to r) Debra Pittillo, Joni Nelson, Sharadia Bolds, Sean Hulsey (client), Rachel Roback, Janice Fry

## Greenwood



(l to r) Luke Christie (client), Peggy Merritt

## Lancaster



(l to r) Courtney Wiggins, Sherri Hilaman, Patricia Dena, Angela Hunter, Tammy Dove, Ryan Steward (client)

## Laurens



(l to r) Rebecca Gillian (client's wife), Jared Gillian (client), Tabitha Speaks, Jocelyn Ellis

## Lexington



(l to r) Deanna Amma, Timothy B. Russell Jr., Tim Jones, John Matthews (client), Gary Horton, Ronald Weed

## Lyman



(l to r) Kenneth Tuckmantel, Jennie Thomas, Giovanna Gomez (client), Julie Atkins, Ward Gray

## Marlboro



(l to r, b to f) Judy Fullard, Cindy Rivers, Tillette Scott, Jameel O. Pearson (client)

## Oconee-Pickens



(l to r) Sheila Ford, Leigh Wright, Jackie Manning (client), Stephanie Whitlock, Randall Hogan, Dan Alexander, Vince Bryant

## Orangeburg



(l to r) John Bates, Stacey Rudd (Manager, Bi-Lo), Kitty Bamberg, Malcolm Tripp Mock (client), Willie Mae Goodwin

## Richland



(l to r) Karen Hill Gordon, Thomas Jackman, Wykesha Hayes, Catherine Russell, Benjamin Knight, Scott Rowe, Akaash Kodali (Client)

## Rock Hill



(l to r) Sylvia Kenley, James Driskell (client), Linda Ratterree

## Spartanburg



(l to r) Luis Luna (client), Barbara Rhodes,  
Leigh-Ann Caudill

## Sumter



(l to r, b to f) Calvin Price, Phyllis Clark, Barry Lee, Beverly  
Montgomery, John Bailey, LeAnetta Benjamin (Client), John Hornsby

## Walterboro



(l to r) Burness Corbett (Owner, Corbett Building Supply),  
Robert Crosby (client), Glen Ackerman

## Williamsburg



(l to r) Lee Helmer (client), Teresa Moses, Sharon Battle,  
David Wiggins, Patricia Gilliard

## South Carolina Assistive Technology Program

CENTER FOR DISABILITY RESOURCES  
SCHOOL OF MEDICINE  
UNIVERSITY OF SOUTH CAROLINA

[scatp.med.sc.edu/](http://scatp.med.sc.edu/)

803-935-5263

1-800-915-4522

# Exhibitors & Sponsors

All Medical

Calcina Insurance Agency

Colonial Life

Freedom Mobility

North American Rescue, LLC

R & R Mobility Vans and Lifts

South Carolina Assistive Technology Program

South Carolina Equipment Distribution Program

South Carolina State Employees Association

## Door Prize Donors

ACS Technologies

A.O. Smith

Aiken Technical College

Anderson Advisory Board

Aunt Laurie's

Beverage Solutions

Big Ant's BBQ

Blue Ridge Electric Co-Operative

Burger King – Verde

Chris Gillespie Sports Photography

Corporate Concepts

Corporate Concepts, Inc.

Countryside Exxon

Craft Stove and Patio

DDS, Administration

DDS, Charleston

DDS, Columbia

DDS, Greenville

DG Golf Management

Embassy Suites, Kingston Plantation

FN Manufacturing

Family Trust Federal Credit Union

FloraLife

Florence School District One

Founders Group International

Freeman Gas

Freightliner

Gaffney OpSource

Green Bus – People & Pets

Hollywood Wax Museum

Hope Health

Interior Design Concepts

K&S International

Lake Marion Golf Course

Lizard's Thicket

Love Chevrolet

McClancy Seasoning

Mobile Power

North American Rescue

Nucor Steel

Orian Rugs

Palmetto Brick Company

Palmetto Goodwill

Palmetto Health Baptist

Palmetto People Development

QAT and PD Tanks

Red Bone Alley Foods

Rempac

Re-Wined Candles

Ruth's Chris Steak House

Santee Cooper Country Club

SCDHHS (Healthy Connections)

Scabbords Technologies

SEW Eurodrive

Southern Patio

Starfish Vision, Inc.

Sunbelt Marketing

Sunoco

Taylor Offshore

Tikiguard, LLC

TQM – Two Rivers Medical

Tupperware

Uline

Upstate Packaging

West Columbia Family Dentistry

WiX Filtration/Mann-Hummel

Woodhill Family Dentistry

Wulbern-Koval Company

# Notes



# Notes



# Notes



# SALES - RENTAL - SERVICE

## VANS & LIFTS

*Driving Independence Forward™*

### 770-483-0767

[www.rrvan.com](http://www.rrvan.com)

RnR Mobility Vans and Lifts, Inc.



### 770-483-0767

[www.rrvan.com](http://www.rrvan.com)